

CMR6272/CMR6272B

700TVL Fixed Lens Bullet IR Camera

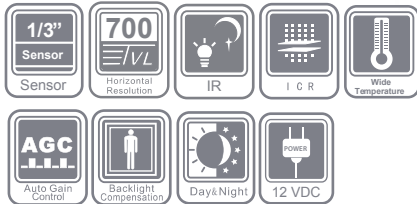

KEY FEATURES

- 700TVL 1/3" Sensor
- 3.6mm Fixed Lens
- 12 IR LEDs up to 30ft
- True Day/Night
- Wide operating temperature range
- DC 12V

SPECIFICATIONS

CMR6272/CMR6272B	
Camera	
Image Sensor	1/3" Sensor
Signal System	NTSC / PAL
Effective Pixels	976 (H) × 496 (V)
Min. Illumination	0.1 Lux @ (F1.2, AGC ON), 0 Lux with IR
Shutter speed	NTSC: 1/60 s to 1/100,000 s PAL: 1/50 s to 1/100,000 s
Lens	3.6 mm
Day & Night	IRcut filter with auto switch
Synchronization	Internal synchronization
Video Output	1Vp-p composite output (75Ω/BNC)
S/N Ratio	More than 62 dB
General	
Working Temperature/Humidity	-40 °C - 60 °C (-40 °F - 140 °F) Humidity 90% or less (non-condensing)
Power Supply	12V DC
Power Consumption	Max. 1.8 W (Max. 4 W with IR cut filter on)
Ingress Protection	IP66
Infrared Red Lamps	12 pcs
IR Range	30 ft
Dimensions	Φ 70×149.5 mm (Φ 2.76"×5.89")
Weight	360 g (0.79 lbs)

DRAWING

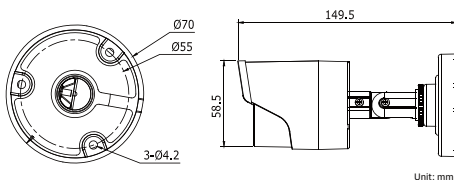

Available models

NTSC : CMR6272, CMR6272B