

LTN7716-P16

Embedded Plug&Play NVR

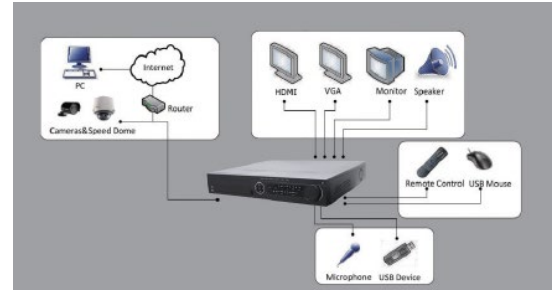

KEY FEATURES

- H.264 video compression
- Third-party network cameras supported
- Up to 5 Megapixels resolution recording
- HDMI and VGA output at up to 1920×1080P resolution
- 4 SATA HDDs up to 16 TB
- HDD quota and group management

Rear Panel of LTN7700



1. Video out
2. CVBS audio out and VGA audio out
3. Line in
4. RS-232 interface
5. VGA interface
6. HDMI interface
7. eSATA interface
8. LAN interface
9. Termination switch
10. RS-485 interface, Controller port, Alarm in and Alarm out
11. Ground
12. AC 100V ~ 240V
13. Power
14. USB interface
15. Network interfaces with PoE function

LTN7716-P16	
Video/Audio input	
IP video input	16-ch
Two-way audio input	1-ch, BNC (2.0 Vp-p, 1kΩ)
Incoming bandwidth	80Mbps
Video/Audio output	
Recording resolution	5MP / 3MP / 1080P / UXGA / 720P / VGA / 4CIF / DCIF / 2CIF / CIF / QCIF
CVBS output	1-ch, BNC (1.0 Vp-p, 75 Ω) Resolution: 704 × 576 (PAL); 704 × 480 (NTSC)
HDMI output	1-ch, resolution: 1920 × 1080P /60Hz, 1920 × 1080P / 50Hz, 1600 × 1200 /60Hz, 1280 × 1024 /60Hz, 1280 × 720 /60Hz, 1024 × 768 /60Hz
VGA output	1-ch, resolution: 1920 × 1080P /60Hz, 1600 × 1200 /60Hz, 1280 × 1024 /60Hz, 1280 × 720 /60Hz, 1024 × 768 /60Hz
Audio output	2-ch, BNC (Linear, 600Ω)
Playback resolution	5MP / 3MP / 1080P / UXGA / 720P / VGA / 4CIF / DCIF / 2CIF / CIF / QCIF
Sync. playback	16-ch
Hard disk	
SATA	4 SATA interfaces for 2 HDDs + 1 DVD-R/W (default), or 4HDDs
eSATA	1 eSATA interface
Capacity	Up to 4TB capacity for each HDD
External interface	
Network interface	1 RJ-45 10 / 100 / 1000 Mbps self-adaptive Ethernet interface 16 independent 100 Mbps PoE network interfaces
Serial interface	1 RS-232 interface (for parameters configuration, maintenance, transparent channel); 1 RS-485 interface (reserved); 1 RS-485 keyboard interface (for special keyboard control)
USB interface	3 × USB 2.0
Alarm in	16
Alarm out	4
General	
Power supply	100 ~ 240VAC, 6.3A, 50 ~ 60Hz
Consumption	≤ 40 W
Working temperature	-10 °C ~ +55 °C
Working humidity	10% ~ 90%
Chassis	19-inch rack-mounted 1.5U chassis
Dimensions	17.5" (W) x 15.25" (D) x 2.75" (H)
Weight	≤ 8 Kg (17.64 lb) (without hard disk or DVD-R/W)